

GRX®

5-FINGER GRAB

Bent body in Strenx® 700
high strength
structural steel

Claws in Hardox® 450
wear-resistant steel

Check valve and
accumulator optional on
GRX 20-5, 25-5 & GRX 30-5



Universal hole pattern for

Angled excavator attachment | RMR compact rotator | WDR worm drive

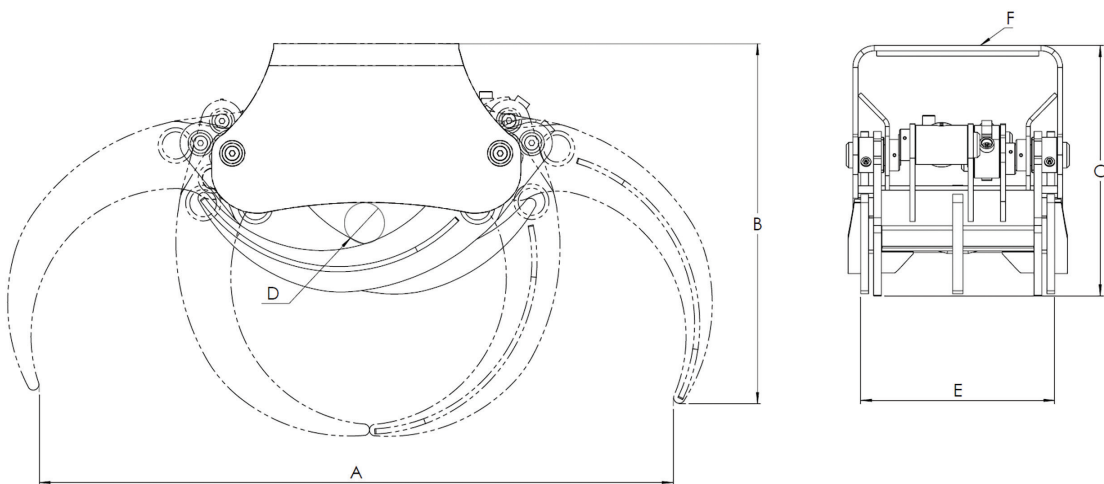

**MAXIMUM STRENGTH.
IDEAL WEIGHT.**

	GRX 10-5	GRX 15-5	GRX 20-5	GRX 25-5	GRX 30-5
A	970	940	1234	1385	1587
B	465	578	688	790	839
C	345	394	485	533	592
D	60	63	78	85	105
E	333	316	377	419	443
F	140x140 M16 Centre Ø110	140x140 M16 205/10 M12 Centre Ø110	140x140 M16 270/16 M16 Centre Ø145	140x140 M16 270/16 M16 Centre Ø145	270/16 M16 340/16 M20 Centre Ø180

MODEL SPECS



MODEL	Kg	m ²	Bar	l/min	kN	ton
GRX 10-5	66	0,10	200	20	7,2	1,5-3
GRX 15-5	95	0,14	200	20	7,2	3-6
GRX 20-5	170	0,19	250	30	11,3	5-9
GRX 25-5	248	0,24	250	40	14,9	8-13
GRX 30-5	306	0,29	300	50	18,3	12-18



MOUNTED WITH RMR COMPACT ROTATOR



Model	Kg	mm	ton
GRX 10-5 / RMR 2	86	970	1,5-2,5
GRX 10-5 / RMR 3	94	970	1,5-3
GRX 15-5 / RMR 3	126	940	2-3,5
GRX 15-5 / RMR 6 C	149	940	3-6
GRX 20-5 / RMR 6 C	234	1234	3,5-6
GRX 20-5 / RMR 8	257	1234	5-8
GRX 25-5 / RMR 8	335	1385	6-8
GRX 25-5 / RMR 12	350	1385	7-12
GRX 30-5 / RMR 12	398	1587	7-12
GRX 30-5 / RMR 16 C	470	1587	12-18